

USER'S MANUAL

VUT 2000 PE EC
VUT 3000 PE EC



**HEAT RECOVERY AIR HANDLING
UNIT**



CONTENTS

Safety requirements	3
Introduction	5
Use	5
Delivery set	5
Designation key	5
Technical parameters	6
Design and operating logic	7
Mounting and set-up	8
Connection to power mains	9
Unit control	10
Maintenance	11
Troubleshooting	12
Storage and transportation rules	13
Manufacturer's warranty	13
Acceptance certificate	14
Seller's information	14
Mounting certificate	14
Warranty card	15







SAFETY REQUIREMENTS

- Read the user’s manual carefully prior to the operation and installation of the heat recovery air handling unit, hereinafter the unit.
- Installation and operation of the unit shall be performed in accordance with the present user’s manual as well as the provisions of all the applicable local and national construction, electrical and technical codes and standards.
- The warnings contained in the user’s manual must be considered most seriously since they contain vital personal safety information.
- Failure to follow the safety regulations may result in an injury or unit damage.
- Read the manual carefully and keep it as long as you use the unit.
- While transferring the unit control the user’s manual must be turned over to the receiving operator.



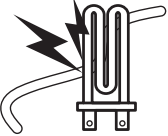
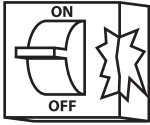

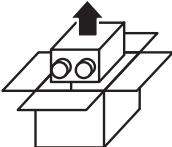
Symbol legend used in the manual:

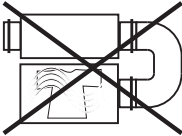
	WARNING!
	DO NOT!

UNIT MOUNTING SAFETY PRECAUTIONS

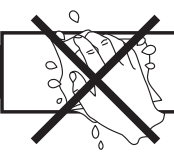
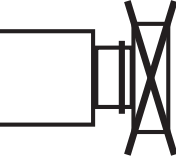
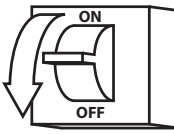
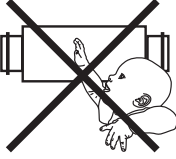
	The unit must be disconnected from the power supply prior to every installation or repair operation.		The unit must not be operated outside the temperature range stated in the user's manual or in aggressive or explosive environments.
	Do not position any heating devices or other equipment in close proximity to the unit power cord.		Do not use damaged equipment or conductors to connect the unit to power mains.
	While installing the unit follow the safety regulations specific to the use of electric tools.		Unpack the unit with care.
	Do not change the power cord length at your own discretion. Do not bend the power cord. Avoid damaging the power cord.		Use the unit only as intended by the manufacturer.

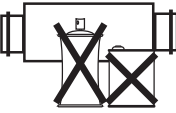
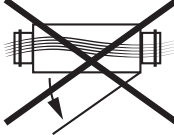
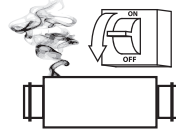
UNIT OPERATION SAFETY PRECAUTIONS

	<p>Do not touch the unit controls with wet hands. Do not carry out the unit maintenance with wet hands.</p>		<p>Do not wash the unit with water. Protect the unit electric parts from water ingress.</p>
	<p>Do not block the air duct when the unit is on.</p>		<p>Disconnect the unit from power supply prior to maintenance.</p>
	<p>Do not let children operate the unit.</p>		<p>Do not damage the power cable while operating the unit. Do not put any objects on the power cable.</p>
	<p>Keep combustible gases and inflammable products away of the unit.</p>		<p>Do not open the operating unit.</p>
	<p>In case of unusual sounds, smoke disconnect the unit from power supply and contact the service centre.</p>		<p>Do not let air flow from the unit be directed to the open flame devices or candles.</p>

INTRODUCTION

This user's manual includes technical description, operation, installation and mounting guidelines, technical data for the heat recovery air handling unit VENTS VUT PE EC, hereinafter referred as the unit.

USE

Due to the ability to save heating energy by means of energy recovery, the unit is an important element of energy-efficient premises. The unit is a component part and is not designed for stand-alone operation.

The unit is designed to ensure mechanical air exchange in houses, offices, hotels, cafés, conference halls, and other utility and public spaces as well as to recover the heat energy contained in the air extracted from the premises to warm up the filtered stream of supply air.

The unit is rated for continuous operation. Transported air must not contain any flammable or explosive mixtures, evaporation of chemicals, sticky substances, fibrous materials, coarse dust, soot and oil particles or environments favorable for the formation of hazardous substances (toxic substances, dust, pathogenic germs).

Relative humidity of transported air must not exceed +20 °C at an ambient humidity of 80 %.



THE UNIT IS NOT INTENDED TO BE USED BY CHILDREN, PHYSICALLY OR MENTALLY DISABLED PERSONS, PERSONS WITH SENSORY DISORDER, PERSONS WITH NO APPROPRIATE QUALIFICATION. ANY OPERATIONS WITH THE UNIT MUST BE PERFORMED ONLY BY PROPERLY QUALIFIED PERSONNEL AFTER THE APPROPRIATE SAFETY BRIEFING. THE UNIT INSTALLATION SITES MUST PREVENT ACCESS BY UNATTENDED CHILDREN.

DELIVERY SET

Unit - 1 item
Control panel - 1 item
User's manual for the air handling unit - 1 item
User's manual for the control panel - 1 item
Packing box - 1 item
Outdoor temperature sensor - 1 item.

DESIGNATION KEY

VUT XXX PE EC X

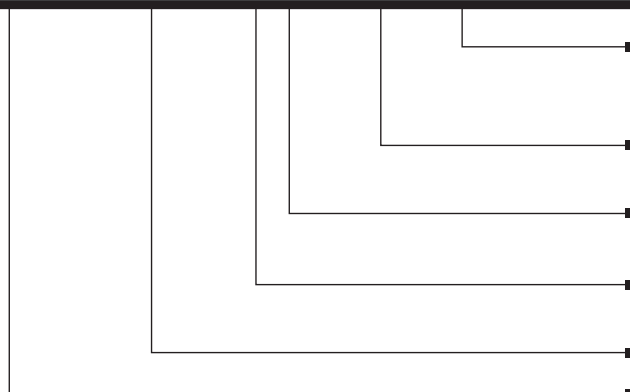

Control panel

___ — PU SENS 01 with a sensor display
A7 — PU JK 01 with a LCD display

Motor type

EC - electronically commutated motor

Heater type

E - electric heater

Mounting option

P - suspended mounting

Rated air capacity [m³/h]

Unit type

VUT - heat recovery ventilation

TECHNICAL PARAMETERS

The unit is designed for indoor application with the ambient temperature ranging from +1 °C up to +40 °C and relative humidity up to 80 %.

In order to prevent condensation on the internal walls of the units, it is necessary that the surface temperature of the casing is 2-3 °C higher than the dew point temperature of the transported air.

The unit is rated as a Class I electrical appliance.

Hazardous parts access and water ingress protection rating:

- IP22 for the unit connected to the air ducts
- IP44 for the unit motors

The unit design is constantly being improved, thus some models may be slightly different from those described in this manual.

UNIT OVERALL DIMENSIONS, MM

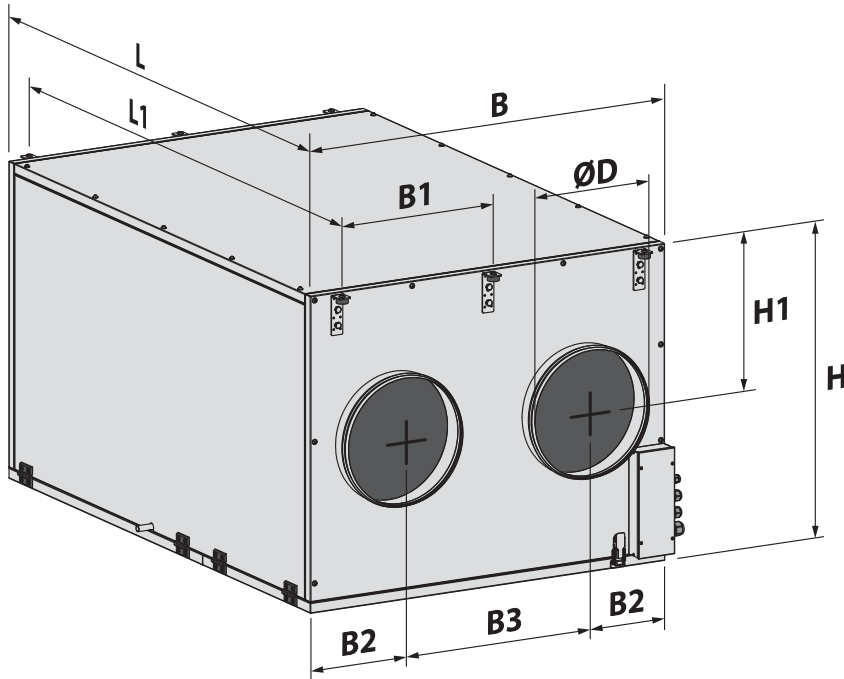

Type	VUT 2000 PE EC	VUT 3000 PE EC
Ø D	314	399
B	950	1265
B1	405	563
B2	225	347
B3	500	570
H	761	881
H1	367	427
L	1400	1835
L1	1453	1888

UNIT TECHNICAL DATA

Type	VUT 2000 PE EC	VUT 3000 PE EC
Voltage, 50 (60) Hz [V]	3 ~ 400	
Max. fan power [W]	2 items x 420	2 items x 990
Max. fan current [A]	2 items x 2,5	2 items x 1,7
Electric heater power [kW]	12,0	21,0
Electric heater current [A]	17,4	30,0
Total unit power [kW]	12,84	23,0
Total unit current [A]	22,4	33,4
Air capacity [m³/h]	2000	4000
Rotation speed [min ⁻¹]	2920	2580
Noise level, 3 m [dB(A)]	58	59
Transported air temperature [°C]	from -25 up to +40	from -25 up to +50
Casing material	Aluzinc	
Insulation	25 mm mineral wool	
Filter:	extract	G4
	supply	G4
Connecting air duct dia. [mm]	Ø 315	Ø 400
Weight [kg]	190	290
Heat recovery efficiency	up to 75%	
Heat exchanger type	Cross-flow	
Heat exchanger material	Aluminium	

DESIGN AND OPERATING LOGIC

The unit operates as follows:

Warm stale extract air from the room flows through the air ducts to the unit, where it is filtered, then air flows through the heat exchanger and is exhausted outside by the extract fan through the air ducts.

Clean cold air from outside is moved by the supply fan to the unit, where from it is directed to the supply filter. Then filtered air flows through the heat exchanger and moves to the room through the air ducts.

Heat energy of warm extract air is transferred to clean intake fresh air from outside and warms it up. Heat recovery minimizes heat energy losses, energy demand and operating costs for air heating accordingly.

The unit is equipped with a detachable service panel for repair works and preventive maintenance and a cover enabling access to the control system components.

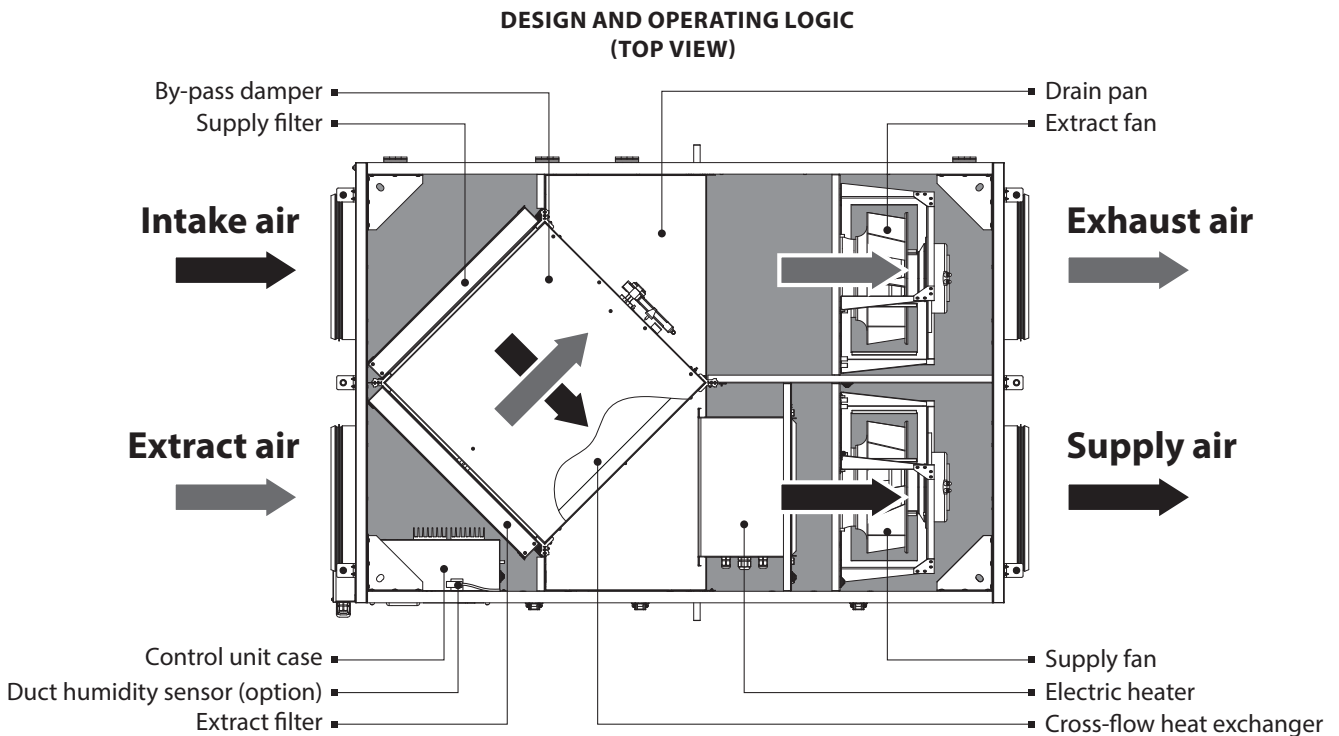

The basic unit delivery set includes a remote control panel for connection to the control system inside the unit casing.

The unit comprises a supply and an extract centrifugal single-inlet fan with forward curved blades and maintenance-free EC motors with external rotor and built-in overheat protection, a plate cross-flow heat exchanger, an electric heater, a supply and an extract filter.

The supply G4 filter cleans supply air flow and prevents contamination of the unit parts. The extract G4 filter prevents contamination of the unit components.

Some condensate may be generated during heat recovery. The condensed fluid is collected in the drain pan and is removed from the unit through the drain pipes.

MOUNTING AND START-UP

UNIT MOUNTING

The unit is designed for suspended mounting by means of the threaded rod fixed in the threaded dowel pin.

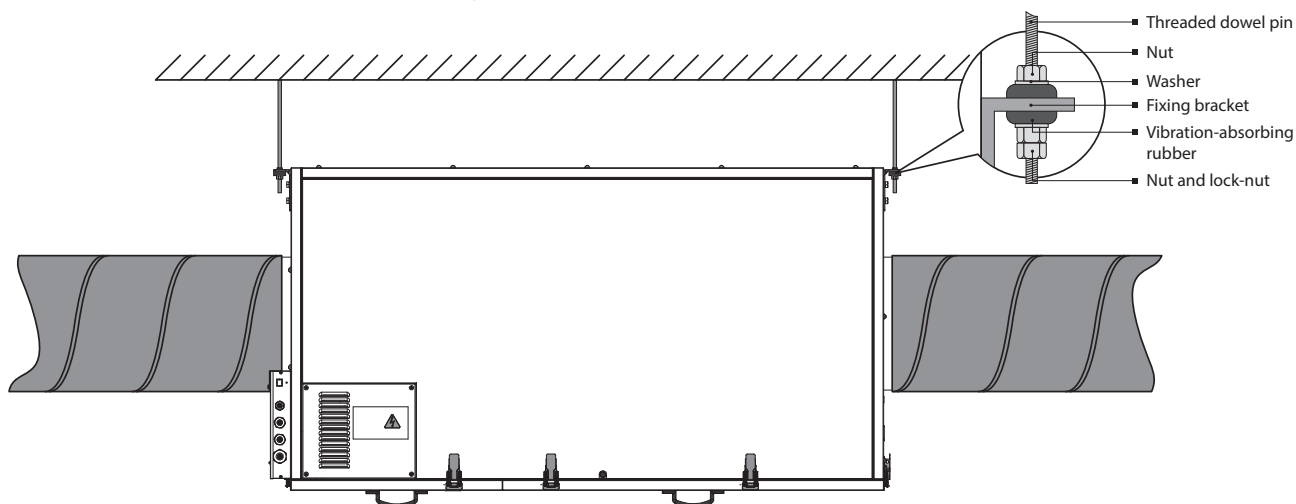

To attain the best performance of the unit and to minimise turbulence-induced air pressure losses while mounting connect a straight air duct section on both sides of the unit.

The minimum straight duct section length must be equal to one air duct diameter on air intake side and three times diameter on air exhaust side.

If the air ducts are not connected or the connected air ducts are too short, protect the unit parts from ingress of foreign objects by covering the spigots with a protecting grille or other protecting device with mesh width not more than 12.5 mm to prevent uncontrollable access to the fans.

SAFETY PRECAUTIONS

The unit is designed for mounting on a rigid and stable structure.

The unit is mounted with anchor bolts. Make sure that a mounting construction has sufficient load capacity matching the unit weight. Otherwise reinforce the installation place by beams, etc.

If the threaded bolts used for the unit mounting are too short, the unit can generate abnormal noise and resonate with the ceiling. The suspended bolts must be long enough to prevent resonating.

If the unit connection place to the spiral seam duct is supposed to be the source of abnormal noise, replace the spiral seam air duct with the flexible one. Optionally the flexible connectors may be used to prevent resonating.

CONDENSATE DRAINAGE

The condensate drain pan in the heat recovery section is equipped with hoses for removal of the condensed fluid outside the unit.

Connect the pipe, U-trap (not included in delivery package) and sewage collection system with metal, plastic or rubber connecting pipes. The pipe slope downwards must be at least 3°. Fill up the system with water before connecting the unit to the power mains! The U-trap must always be filled with water during the unit operation. Make sure that the water flows freely into the sewage collection system or otherwise condensed water may build up in the unit during the heat exchanger operation and cause equipment failure and condensed water outflow into the premises.

The condensate drainage system is designed for normal operation in premises with air temperatures above 0 °C. If the expected ambient air temperatures are below 0 °C the condensate drainage system must be equipped with heat insulation and pre-heating facilities.

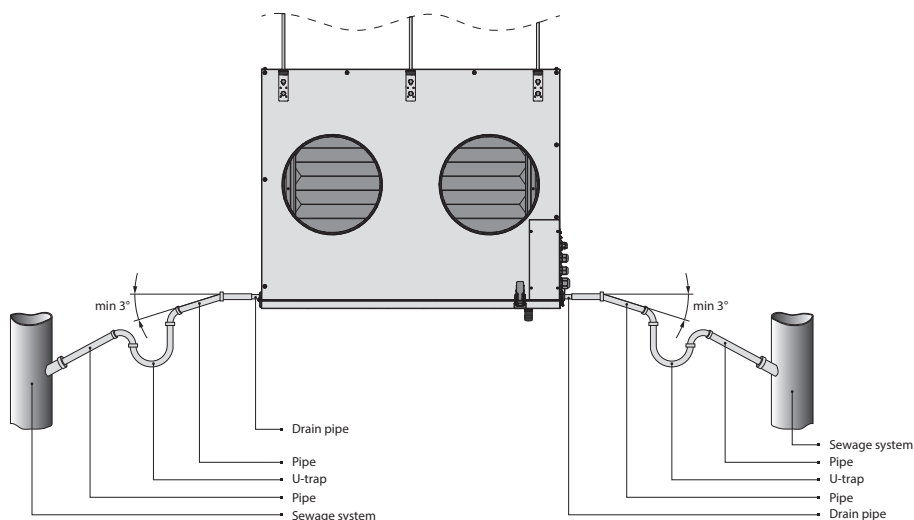

**DO NOT CONNECT SEVERAL DRAIN PIPES FROM SEVERAL AIR HANDLING UNITS TO ONE U-TRAP!
DIRECT CONDENSATE OUTSIDE WITHOUT CONNECTION TO DRAIN SYSTEM IS NOT ALLOWED!**

OUTDOOR TEMPERATURE SENSOR INSTALLATION

Mounting of the outdoor temperature sensor:

1. Remove two screws from the sensor cover.
2. Take off the cover from the sensor.
3. Install the sensor on the outside wall. The wall must not be exposed to direct sunlight.
4. Install the sensor cover back.

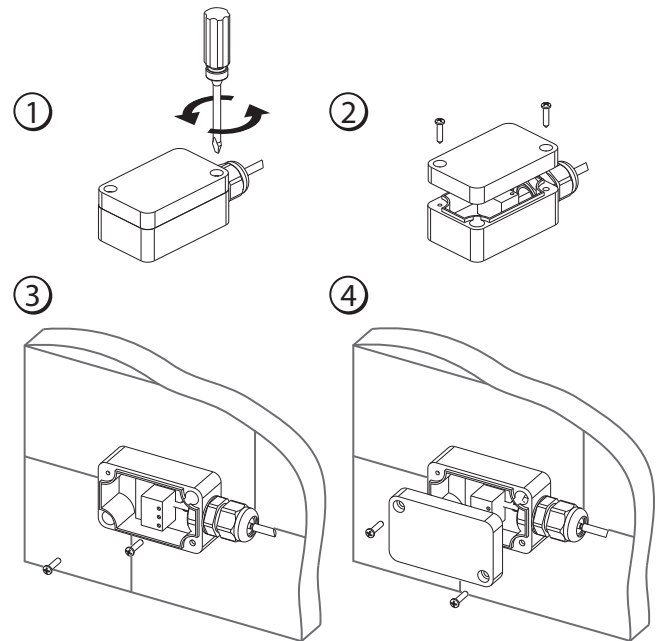

CONNECTION TO POWER MAINS



DISCONNECT THE UNIT FROM POWER MAINS PRIOR TO ANY ELECTRIC INSTALLATION OPERATIONS.

CONNECTION OF THE UNIT TO POWER MAINS IS ALLOWED BY A QUALIFIED ELECTRICIAN WITH A WORK PERMIT FOR THE ELECTRIC UNITS UP TO 1000 V AFTER DETAILED STUDY OF THE PRESENT USER'S MANUAL.

THE RATED ELECTRICAL PARAMETERS OF THE UNIT ARE SHOWN ON THE RATING PLATE. ANY INTERNAL CONNECTION MODIFICATIONS ARE NOT ALLOWED AND RESULT IN WARRANTY LOSS.

The unit is rated for connection to three-phase ac 400 V / 50 Hz. The unit shall be connected to power supply by means of insulated, durable and thermal-resistant cords (cables, wires) with respective cross section, in any case no less than 4 mm². The above cross section is for reference only. The applicable cable must be selected in consideration of the maximum wire temperature depending on the wire and insulation type, the maximum current, the lead wire length and its installation method.»

Use copper wires only.

Connect the unit to power mains through the terminal block which is located in the terminal box on the side of the unit, in compliance with the wiring diagram and the terminal marking. Connect all the control and supply cables in compliance with the terminal marking and polarity!

Connect the unit to power mains through an external thermal-magnetic circuit breaker integrated into the fixed wiring system. The trip current should be not below the current consumption.

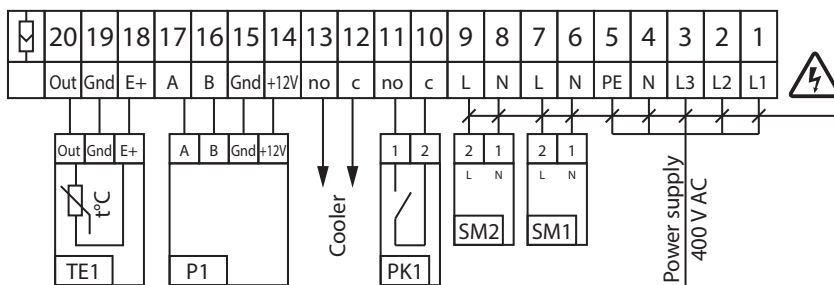

Name	Наименование	Type	Wire
Cooler	DX cooler	NO	2 x 0,75 mm ²
SM1	Supply air damper actuator	LF230	2 x 0,75 mm ²
SM2	Extract air damper actuator	LF230	2 x 0,75 mm ²
PK1	Contact from fire alarm panel	NO	2 x 0,75 mm ²
P1**	Remote control		4 x 0,75 mm ²
TE1	Outdoor temperature sensor		3 x 0,75 mm ²

1. The unit delivery set includes P1 and TE1 only.
2. ** Maximum connecting cable length is 20 m!



— ELECTRIC SHOCK HAZARD!

HV1 duct humidity sensor is a special accessory that is not included into the delivery set. To install the sensor connect the humidity sensor socket connector XS7 to the socket connector XS7 inside the unit. Then fix the sensor with the clamp and the holder in the extract air duct upstream of the heat exchanger.

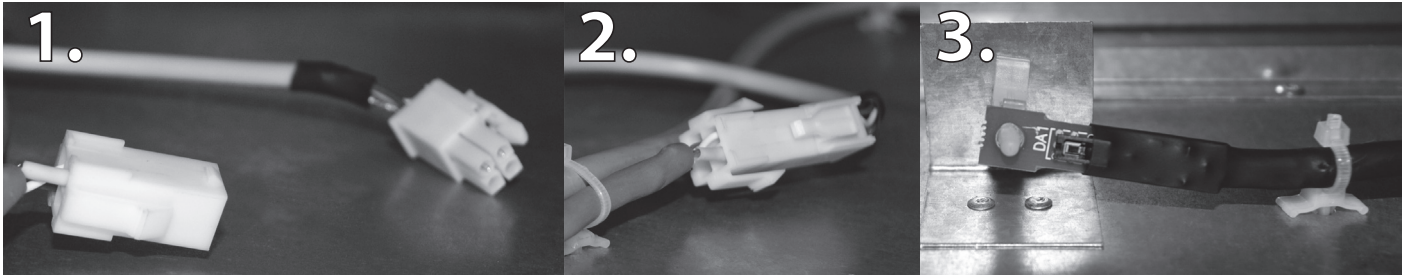

FUNCTIONAL DIAGRAM

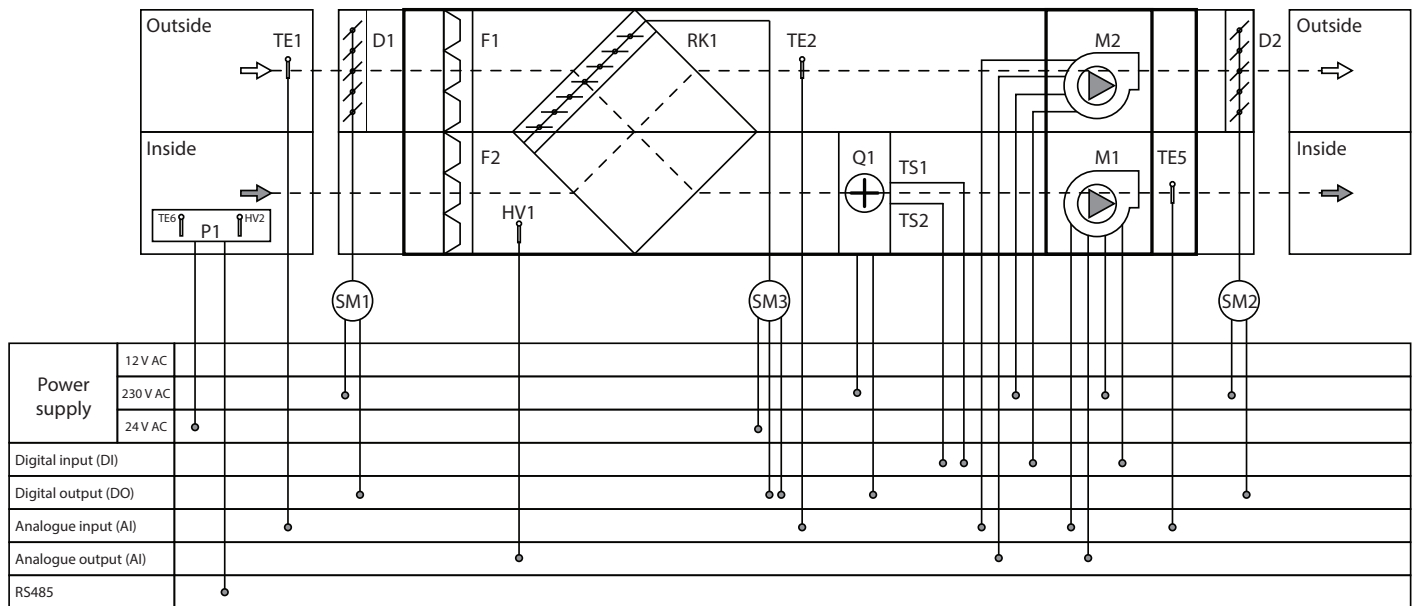

Designation	Name
D1*	Supply air damper
D2*	Extract air damper
F1	Supply filter
F2	Extract filter
M1	Supply fan
M2	Exhaust fan
P1	Control panel
Q1	Electric air heater
RK1	Plate heat exchanger
SM1*	Supply damper actuator
SM2*	Extract damper actuator
SM3	Bypass damper electric actuator
TE1	Outer air temperature sensor
TE2	Temperature sensor at heat exchanger outlet
TE5	Duct temperature sensor
TE6	Room air temperature sensor (included in the control panel delivery set)
TS1	Overheat protection thermostat actuated at +60°C with automatic reset
TS2	Overheat protection thermostat actuated at +90°C with manual reset
HV1*	Duct humidity sensor
HV2	Indoor humidity sensor

* Not included into the delivery set, available on separate order

MAINTENANCE

The recommended maintenance periodicity is 3-4 times per year. The maintenance and servicing routines include regular cleaning and the following operations:

1. Filter maintenance (3-4 times a year).

Contaminated filters increase air resistance thus impairing supply air volume into the premises. Clean the filters as these get dirty, but at least 3-4 times a year. Use a vacuum cleaner to remove the contamination or use new filters. Change the filters after the second cleaning. New filters can be purchased from the unit seller.

Filter removing:

1. Unlatch the service panel.
2. Support the service panel with a hand and open it.
3. Remove the filters from the unit.

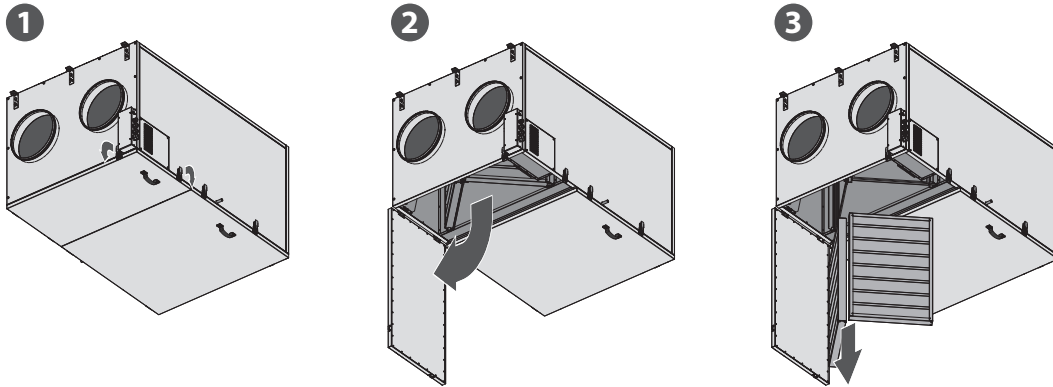

2. Heat exchanger checking (once a year).

Even regular filter technical maintenance may not completely prevent dirt accumulation on the heat exchanger unit. Clean the heat exchanger on a regular basis to ensure its high heat recovery efficiency. To clean the heat exchanger remove it from the unit and wash it with warm neutral detergent solution. Re-install the dry heat exchanger back into the unit.

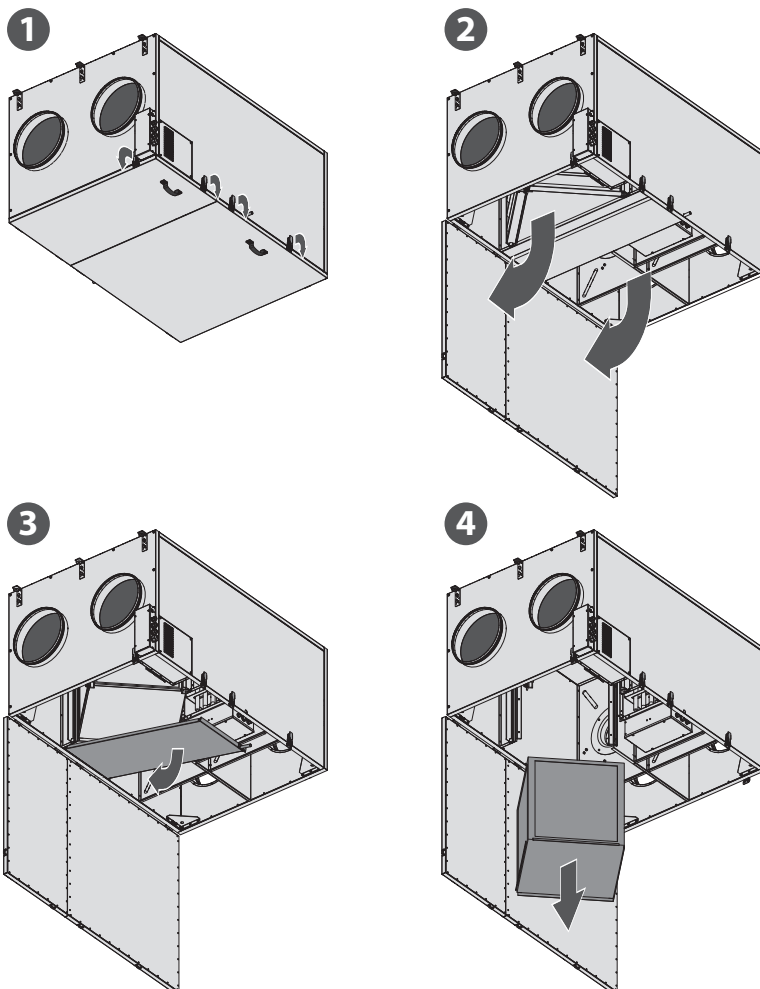

Removing the heat exchangers:

1. Unlatch the service panel.
2. Support the service panels with a hand and open those.
3. Remove the four screws to take the drain pan off.
4. Remove the nine retaining screws off the heat exchanger and remove the heat exchanger carefully from the unit.

3. Fan inspection (once a year).

Even regular technical maintenance of the filters and heat exchanger may not completely prevent dust accumulation in the fans which reduces the fan capacity and impairs supply air volume into the premises.

Clean the fans with a cloth or a soft brush. Do not use water, aggressive solvents, sharp objects etc. for cleaning not to damage the impeller.

4. Condensate drain checking (once a year).

The drain pipes may get clogged with the extracted particles. Pour some water inside the drain pan and check the pipe for clogging. Clean the U-trap and drain pipe if required.

5. Extract and supply diffuser cleaning (as required).

Remove the diffusers and louver shutters and wash these with warm mild detergent solution.

6. Air intake checking (twice a year).

Leaves and other pollutions can clog the supply air grille and reduce the unit performance and supply air volume. Check the supply grille twice per year and clean it as required.

7. Duct system checking (every 5 years).

Even regular fulfilling of all the prescribed above maintenance operations may not completely prevent dust accumulation in the air ducts which reduces the unit performance. The air duct maintenance includes regular cleaning or replacement.

TROUBLESHOOTING**POSSIBLE FAULTS AND TROUBLESHOOTING**

Fault	Possible reasons	Fault handling
The fan does not start up during the unit start-up.	No power supply.	Make sure the unit is properly connected to power mains, otherwise troubleshoot a connection error.
	Motor is jammed, the impeller are clogged.	Turn the unit off. Troubleshoot the motor jam and the impeller clogging. Clean the blades. Restart the unit.
	System alarm.	For troubleshooting of the control system errors refer to the control panel manual.
Circuit breaker tripping following the unit turning on.	Overcurrent as a result of short circuit in the electric circuit.	Turn the unit off. Contact the service centre.
Low air flow.	Low set fan speed.	Set higher speed.
	The filters, the fans or the heat exchanger are contaminated.	Clean or replace the filters, clean the fans and the heat exchanger.
	The air ducts, diffusers, louver shutters, grilles are clogged or contaminated.	Clean or replace ventilation system components as air ducts, diffusers, louver shutters, grilles.
	The air dampers, diffusers or louver shutters are closed.	Make sure the air dampers, diffusers or louver shutters are fully opened.
Low supply air temperature.	The extract filter is soiled.	Clean or replace the extract filter.
	The heat exchanger is frozen.	Check the heat exchanger condition. Turn the unit off and restart it after the heat exchanger freezing danger is no longer imminent.
	Electric heater malfunction.	Contact the unit seller for troubleshooting.
High noise, vibration.	The impeller is soiled.	Clean the impeller.
	The fan or casing screw connection is loose.	Tighten the screw connection in the fan or the casing against stop.
	No anti-vibration dampers.	Install anti-vibration rubber mounts.
Condensate leakage.	The drain line is clogged, damaged or wrong mounted.	Clean the drain line, if necessary. Check the drain line slant, inspect the U-trap and make sure the drain line is equipped with frost protection.

STORAGE AND TRANSPORTATION RULES

Store the unit in the manufacturer's original packing box in a dry ventilated premise at the temperatures from +5 °C up to +40 °C and relative humidity up to 80%.

Storage environment must not contain aggressive vapours and chemical mixtures provoking corrosion, insulation and sealing deformation.

Use hoist machinery for handling and storage operations to prevent the unit damage. Fulfil the handling requirements applicable for the applicable freight type.

Transportation with any vehicle type is allowed provided that the unit is protected against mechanical and weather damage.

Avoid any mechanical shocks and strokes during handling operations.

MANUFACTURER'S WARRANTY

The manufacturer hereby warrants normal operation of the unit over the period of 24 months from the retail sale date provided the user's observance of the transportation, storage, installation and operation regulations.

Should any malfunctions occur during the unit operation through the manufacturer's fault during the warranty period the user is entitled to elimination of faults by means of warranty repair performed by the manufacturer.

The warranty repair includes work specific to elimination of faults in the unit operation to ensure its intended use by the user within the warranty period. The faults are eliminated by means of replacement or repair of the complete unit or the faulty part thereof.

The warranty repair does not include:

- Routine maintenance;
- Unit installation / dismantling;
- Unit setup.

To benefit from warranty repair the user must provide the unit, the user's manual with stamped sale date and the payment document certifying the purchase.

The unit model must comply with the one stated in the user's manual.

Contact the unit Seller for warranty service.

The manufacturer's warranty does not apply to the following cases:

- User's failure to provide the unit with the entire delivery package as stated in the user's manual or with missing component parts previously dismantled by the user;
- Mismatch of the unit model and make with the respective details stated on the unit packing and in the user's manual;
- User's failure to ensure timely technical maintenance of the unit;
- External damage to the casing (excluding external modifications of the unit as required for its installation) and the internal components of the unit;
- Alteration of the unit design or engineering changes of the unit;
- Replacement and use of the unit assemblies, parts and components not approved by the manufacturer;
- Unit misuse;
- User's violation of the unit installation regulations;
- User's violation of the unit management regulations;
- Unit connection to the power mains with a voltage different from the one stated in the user's manual;
- Unit breakdown due to voltage surges in the power mains;
- User's discretionary repair of the unit;
- Unit repair performed by any persons without the manufacturer's authorization;
- Expiry of the unit warranty period;
- User's violation of the established regulations specific to the unit transportation;
- User's violation of the unit storage regulations;
- Wrongful acts against the unit committed by third persons;
- Unit breakdown due to circumstances of insuperable force (fire, flood, earthquake, war, hostilities of any kind, or blockade);
- Missing seals if provided by the user's manual;
- Failure to provide the user's manual with the sale date stamp;
- Missing payment document certifying the unit purchase.



FOLLOWING THE REGULATIONS STIPULATED HEREIN WILL ENSURE A LONG AND TROUBLE-FREE OPERATION OF THE UNIT.



USERS' CLAIMS SHALL BE SUBJECT TO REVIEW ONLY UPON PRESENTATION OF THE UNIT, THE PAYMENT DOCUMENT AND THE USER'S MANUAL WITH THE SALE DATE STAMP.

ACCEPTANCE CERTIFICATE

Product Type	Heat recovery air handling unit
Model	VUT_____PE EC_____
Serial Number	
Manufacturing Date	
<p>is compliant with the technical specifications and is hereby declared ready for service. We hereby declare that the product complies with the essential protection requirements of Electromagnetic Council Directive 2004/108/EC, 89/336/EEC and Low Voltage Directive 2006/95/EC, 73/23/EEC and CE-marking Directive 93/68/EEC on the approximation of the laws of the Member States relating to electromagnetic compatibility. This certificate is issued following test carried out on samples of the product referred to above.</p>	
Quality Inspector's Stamp	

SELLER'S INFORMATION

Shop name	
Address	
Phone number	
E-mail	
Sales date	
<p>This is to certify delivery of the complete unit with the user's manual. The warranty terms are acknowledged and accepted.</p>	
Customer's signature	

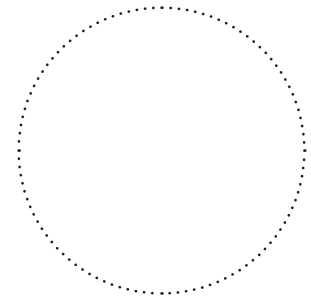

Seller's seal

MOUNTING CERTIFICATE

<p>VUT___ PE EC _____ unit has been connected to power mains pursuant to the requirements stated in the present user's manual.</p>	
Company name	
Address	
Phone number	
Installation technician's full name	
Installation date:	Signature:

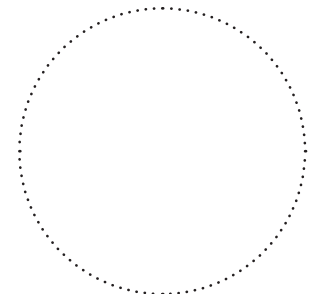
Installation technician's
company seal

<p>This is to certify that the work specific to the unit installation has been performed in accordance with all the applicable provisions of local and national construction, electrical and technical codes and standards. The unit operates normally as intended by the manufacturer.</p>	
Signature:	

WARRANTY CARD

Product type	Heat recovery air handling unit
Model	VUT____PE EC ____
Serial number	
Manufacturing date	
Sales date	
Warranty period	
Sales company	

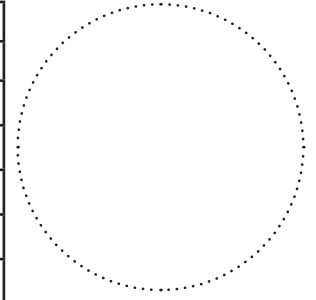

Seller's seal

A large rectangular area with a light gray border, containing ten horizontal lines for writing. A small circular logo is located in the bottom right corner of this area.

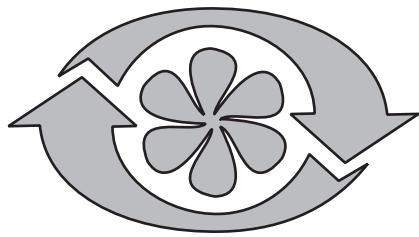

VENTS